

UNITED STATES DEPARTMENT OF THE INTERIOR
NATIONAL PARK SERVICE

FOR NPS USE ONLY
RECEIVED
DATE ENTERED

NATIONAL REGISTER OF HISTORIC PLACES
INVENTORY -- NOMINATION FORM

SEE INSTRUCTIONS IN HOW TO COMPLETE NATIONAL REGISTER FORMS
TYPE ALL ENTRIES -- COMPLETE APPLICABLE SECTIONS

1 NAME

HISTORIC

Hales, W. T., House
AND/OR COMMON

2 LOCATION

STREET & NUMBER

1521 N. Hudson

CITY, TOWN

Oklahoma City

NOT FOR PUBLICATION

CONGRESSIONAL DISTRICT

No. 5

STATE

Oklahoma

VICINITY OF

CODE

40

COUNTY

Oklahoma

CODE

109

3 CLASSIFICATION

CATEGORY

OWNERSHIP

STATUS

PRESENT USE

___DISTRICT

___PUBLIC

OCCUPIED

___AGRICULTURE

___MUSEUM

BUILDING(S)

PRIVATE

___UNOCCUPIED

___COMMERCIAL

___PARK

___STRUCTURE

___BOTH

___WORK IN PROGRESS

___EDUCATIONAL

___PRIVATE RESIDENCE

___SITE

PUBLIC ACQUISITION

ACCESSIBLE

___ENTERTAINMENT

RELIGIOUS

___OBJECT

___IN PROCESS

YES: RESTRICTED

___GOVERNMENT

___SCIENTIFIC

___BEING CONSIDERED

___YES: UNRESTRICTED

___INDUSTRIAL

___TRANSPORTATION

___NO

___MILITARY

___OTHER:

4 OWNER OF PROPERTY

NAME

Archdioces, Roman Catholic Church

STREET & NUMBER

1521 N. Hudson

CITY, TOWN

Oklahoma City

STATE

Oklahoma

5 LOCATION OF LEGAL DESCRIPTION

COURTHOUSE,

REGISTRY OF DEEDS, ETC.

Office of the County Clerk

STREET & NUMBER

Oklahoma County Courthouse

CITY, TOWN

Oklahoma City

STATE

Oklahoma

6 REPRESENTATION IN EXISTING SURVEYS

TITLE

Special Hales House Survey

DATE

1976

___FEDERAL STATE ___COUNTY ___LOCAL

DEPOSITORY FOR SURVEY RECORDS

Oklahoma Historical Society

CITY, TOWN

Oklahoma City

STATE

Oklahoma

DESCRIPTION

| | | | |
|---|---------------------------------------|---|---|
| CONDITION | | CHECK ONE | CHECK ONE |
| <input checked="" type="checkbox"/> EXCELLENT | <input type="checkbox"/> DETERIORATED | <input checked="" type="checkbox"/> UNALTERED | <input checked="" type="checkbox"/> ORIGINAL SITE |
| <input type="checkbox"/> GOOD | <input type="checkbox"/> RUINS | <input type="checkbox"/> ALTERED (basically) | <input type="checkbox"/> MOVED DATE _____ |
| <input type="checkbox"/> FAIR | <input type="checkbox"/> UNEXPOSED | | |

DESCRIBE THE PRESENT AND ORIGINAL (IF KNOWN) PHYSICAL APPEARANCE

The Hales home at 1521 N. Hudson, considered one of the finest in Oklahoma City when completed in 1916, was designed by the local firm of Hawk and Parr. George Hodel of Chicago was responsible for the furnishings. An estimated \$125,000 was spent on the house itself, an equal amount on the interior. The three-story structure was built of Bedford stone and special gray brick imported from Greece.

The house with its formal entrance portico, supported by eight massive Corinthian, faces the east. On the north is a more restrained, but none the less formal, portico over the horseshoe-shaped carriage entrance. A covered service entrance is on the west, beyond which stretches the garden with its fountain and flower beds. (The Shrine at the end of the garden against the west property line was added after the Catholic church acquired the home in 1939.) The driveway in from Hudson skirts the south side of the house to serve a two-story garage/service quarters structure of similar design and construction.

There is a great hall in the center of the main floor which can comfortably accommodate a hundred people. At the north end is the grand staircase, flanked by two carved wooden lions, that leads to the second floor. There originally was another large hall, but it has now been converted into a chapel.

Adjoining the grand hall on the east is a large music room. This room is accentuated by a delicately carved white molding around the ceiling. An oval of white carved roses on the ceiling encircles a large chandelier. The white carving is further seen on the fireplace mantle above a marble hearth. On the south end of the room a door leads into a small entrance hall leading off the east entrance. Beyond that is the library with fireplace and marble hearth. Immediately to the south of the great hall is the Italian dining room. Wood wainscoting to eye level is seen along with a beautiful mantle of wood featuring carved grapevines. Again the fireplace is equipped with marble hearth. Doors lead from the dining room into the office, morning room, and great hall. Northeast of the great hall is a sitting room featuring yet another marble fireplace. Also on the main floor is the kitchen, a smaller dining room, and a sewing room.

On the second floor, in addition to the large hall (now converted into a chapel), were several bedrooms and baths. An interesting feature: the carved wooden gargoyles on the ceiling molding. The third floor accommodates a grand ballroom roughly the same size as the downstairs great hall. Rooms which were originally designed as anterooms for musicians or porches where guests could relax have been converted into living areas. There is also a small chapel located at the north end of the third floor. At the time the Catholics bought the house it contained six bathrooms.

The Hodel furnishings included hand-tufted rugs imported from Ireland, Austria, and China. Drapery fabrics were woven to order in France and Italy. Most of the furniture was made of French walnut. The house also featured a \$10,000 elevator and an 8 x 10-foot vault for the storage of valuables.

SIGNIFICANCE

| PERIOD | AREAS OF SIGNIFICANCE -- CHECK AND JUSTIFY BELOW | | | |
|---|--|---|---|--|
| <input type="checkbox"/> PREHISTORIC | <input type="checkbox"/> ARCHEOLOGY-PREHISTORIC | <input type="checkbox"/> COMMUNITY PLANNING | <input type="checkbox"/> LANDSCAPE ARCHITECTURE | <input checked="" type="checkbox"/> RELIGION |
| <input type="checkbox"/> 1400-1499 | <input type="checkbox"/> ARCHEOLOGY-HISTORIC | <input type="checkbox"/> CONSERVATION | <input type="checkbox"/> LAW | <input type="checkbox"/> SCIENCE |
| <input type="checkbox"/> 1500-1599 | <input type="checkbox"/> AGRICULTURE | <input type="checkbox"/> ECONOMICS | <input type="checkbox"/> LITERATURE | <input type="checkbox"/> SCULPTURE |
| <input type="checkbox"/> 1600-1699 | <input checked="" type="checkbox"/> ARCHITECTURE | <input type="checkbox"/> EDUCATION | <input type="checkbox"/> MILITARY | <input type="checkbox"/> SOCIAL/HUMANITARIAN |
| <input type="checkbox"/> 1700-1799 | <input type="checkbox"/> ART | <input type="checkbox"/> ENGINEERING | <input type="checkbox"/> MUSIC | <input type="checkbox"/> THEATER |
| <input type="checkbox"/> 1800-1899 | <input checked="" type="checkbox"/> COMMERCE | <input type="checkbox"/> EXPLORATION/SETTLEMENT | <input type="checkbox"/> PHILOSOPHY | <input type="checkbox"/> TRANSPORTATION |
| <input checked="" type="checkbox"/> 1900- | <input type="checkbox"/> COMMUNICATIONS | <input type="checkbox"/> INDUSTRY | <input type="checkbox"/> POLITICS/GOVERNMENT | <input type="checkbox"/> OTHER (SPECIFY) |
| | | <input type="checkbox"/> INVENTION | | |

SPECIFIC DATES 1916 to present

BUILDER/ARCHITECT Hawk and Parr

STATEMENT OF SIGNIFICANCE

Time was when a teenager considered "cute" by fond relatives - and "smart alec" by those burdened with no such natural prejudice - would upon occasion (that is, when in the presence of his peers) answer the phone with a crisp "Mule Barn." The current bishop of the Oklahoma Diocese of the Catholic church is that rare adult who could - but almost surely would not - pick up the telephone in his Queen Anne bedroom/office and startle his caller with a similar greeting. His official residence is, in reality, a mansion built by mules.

* * *

William T. Hales was 17 when he came to Oklahoma City from Missouri in 1890 ... in a covered wagon with a dog, a pistol, and a rifle. He began selling horses and mules, eventually owning what was said to be the largest mule barn in the state. As he made money, he invested it wisely - in real estate, oil, and other ventures, - this in a new and growing city and state - and became one of Oklahoma City's financial leaders. He was also a banker and played an important role in establishing the meat packing industry in the city. Just before and during the early years of World War I, when the horse and mule business was especially lucrative, Hales filled important contracts with both the U. S. and foreign governments. At last he was ready to move on beyond wealth to yet another of his goals in life - to own the largest home in Oklahoma City. He did, moving into in July 1916. And the handsome Hales Mansion, sold to the church in 1939 following Hales' death in 1938, clings to its "largest" status even today.

9 MAJOR BIBLIOGRAPHICAL REFERENCES

Howell, Joseph E., "Bishop of Tulsa and Oklahoma City in \$250,000 Mansion,"
The Tulsa Tribune, June 18, 1939

Stewart, Roy P., Born Grown, Oklahoma City, Fidelity National Bank, 1974, p. 196

Miscellaneous materials from the Oklahoma Historical Society and the Oklahoma City Historic Preservation Commission

10 GEOGRAPHICAL DATA

ACREAGE OF NOMINATED PROPERTY less than one acre

UTM REFERENCES

| | | | |
|------|---------|----------|---------|
| A | 14 | 634338 | 3927719 |
| ZONE | EASTING | NORTHING | |

| | | | |
|------|---------|----------|--|
| B | | | |
| ZONE | EASTING | NORTHING | |

VERBAL BOUNDARY DESCRIPTION

LIST ALL STATES AND COUNTIES FOR PROPERTIES OVERLAPPING STATE OR COUNTY BOUNDARIES

| STATE | CODE | COUNTY | CODE |
|-------|------|--------|------|
|-------|------|--------|------|

| STATE | CODE | COUNTY | CODE |
|-------|------|--------|------|
|-------|------|--------|------|

11 FORM PREPARED BY

NAME / TITLE

Kent Ruth, Deputy

ORGANIZATION

Oklahoma Historical Society

STREET & NUMBER

Historical Building

CITY OR TOWN

Oklahoma City

DATE

September 1977

TELEPHONE

405/884-5456

STATE

Oklahoma

12 STATE HISTORIC PRESERVATION OFFICER CERTIFICATION

THE EVALUATED SIGNIFICANCE OF THIS PROPERTY WITHIN THE STATE IS:

NATIONAL

STATE

LOCAL

As the designated State Historic Preservation Officer for the National Historic Preservation Act of 1966 (Public Law 89-665), I hereby nominate this property for inclusion in the National Register and certify that it has been evaluated according to the criteria and procedures set forth by the National Park Service.

STATE HISTORIC PRESERVATION OFFICER SIGNATURE

TITLE

DATE

FOR NPS USE ONLY

I HEREBY CERTIFY THAT THIS PROPERTY IS INCLUDED IN THE NATIONAL REGISTER

DATE

DIRECTOR, OFFICE OF ARCHEOLOGY AND HISTORIC PRESERVATION

ATTEST:

DATE

KEEPER OF THE NATIONAL REGISTER



W.T. Hales House



Hales, W. T., House

OKLAHOMA CITY QUADRANGLE
OKLAHOMA

7.5 MINUTE SERIES (TOPOGRAPHIC)

NE/4 OKLAHOMA CITY 15' QUADRANGLE
GUTHRIE 2 1/2 MI.
2.1 MI. TO U.S. 66

(SPENCER)
6355 (11 SW)

14/634/338/3927719

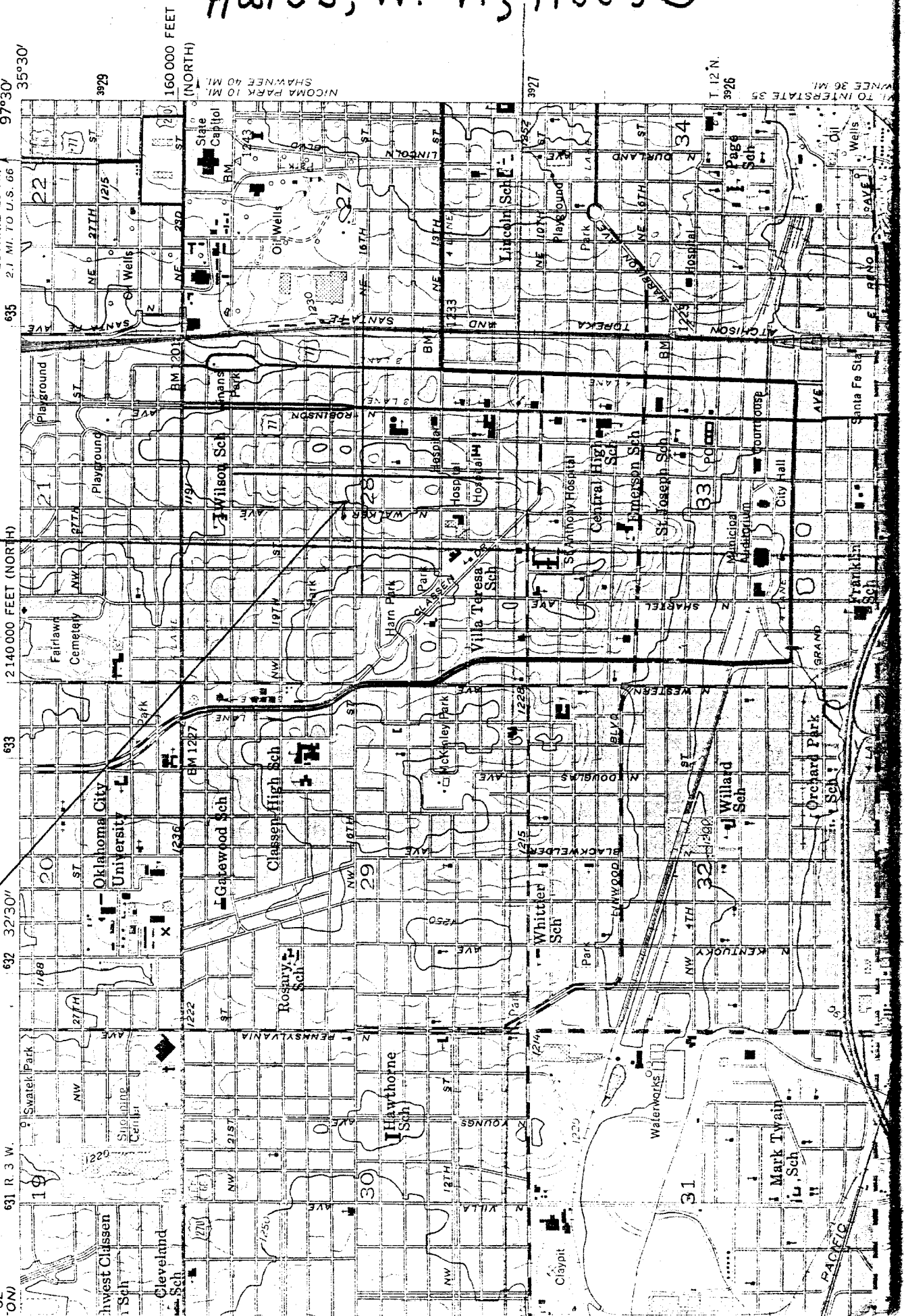

631 R. 3 W. 632 32/30" 633 2140,000 FEET (NORTH) 635 21 MI. TO U.S. 66 97°30' 35°30' 160,000 FEET (NORTH) N. COOMA PARK 10 MI. SHAWNEE 40 MI.

Labels on map:
Fairview Cemetery
Oklahoma City University
Rosary Sch
Hawthorne Sch
Gateway Sch
Classen High Sch
Wilson Sch
St. Joseph Sch
Central High Sch
Emperson Sch
St. Anthony Hospital
St. Joseph Hospital
Villa Teresa Sch
Whittier Sch
Willard Sch
Orchard Park Sch
City Hall
Municipal Auditorium
Horn Park
Tackley Park
Claypit
Water Works
Mark Twain Sch
Franklin Sch
Santa Fe Sta
City Hall
City Hall

634 R. 3 W. 635 T. 12 N. 3926 I. TO INTERSTATE 35 WYNNE 36 MI.